

CODE	DESCRIPTION	CODE	DESCRIPTION	CODE	DESCRIPTION
AC010.003	Connection rest. 1/4"	SI009.060	Connecting-rod	VB003.005	Screw for filter
EX041.060	Piston seal	SI009.160	Connecting-rod complete of bearing and crank	VB004.005	Screw for valve
MSI001. _	Electric motor 0,5 Hp	SI011.060	Cylinder	VB005.005	Screw for cylinder
SI002.001	Head	SI011.160	Cylinder complete of filter and connection	VB006.010	Screw for bearing connecting-rod
SI003.001	Top gasket	SI012.001	Crank	VB006.020	Screw for piston top
SI004.001	Valve	SI017.001	Plastic fan standard	VB006.035	Screw for top
SI005.001	Valve plate	SI019.0_	Condenser ____ µF	VD004.005	Washer for valve
SI005.101	Valve plate complete	SI034.060	Piston top	VR004.005	Nut for valve
SI006.030	Cylinder gasket 0,30 mm	SI036.001	Cover filter		
SI006.050	Cylinder gasket 0,50 mm	SI037.001	Filter		
SI006.080	Cylinder gasket 0,80 mm	SI039.001	Bearing connecting-rod		

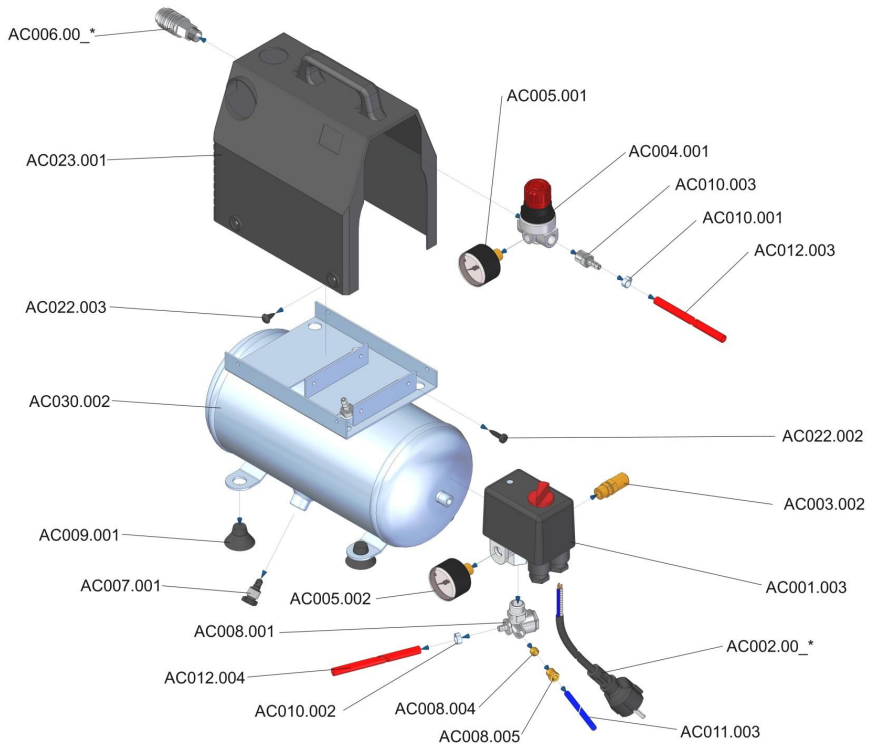

CODE	DESCRIPTION	CODE	DESCRIPTION	CODE	DESCRIPTION
AC001.002	Pressure Switch 3/8" (start valve close)	AC006.005	Nut for Bayonet connection	AC011.003	Blue Rilsan tube SILVERSTONE 2
AC002.001	Pin plug SHUKO 1,5 m	AC007.001	Plastic screw for condensate drain	AC012.003	Red Rilsan tube SILV. 2 for Pressure Regulator
AC002.005	Pin plug ENGLISH 1,5 m	AC008.001	Not return valve 3/8" for tube Rilsan	AC012.004	Red Rilsan tube SILV. 2 for non return valve
AC003.002	Safety valve 8 BAR	AC008.004	Ogive for tube blue Rilsan	AC022.002	Screw for Silverstone engine
AC004.001	Pressure regulator MIGNON Pos.1	AC008.005	Nut for tube blue Rilsan	AC022.003	Screw for Plastic cover
AC005.001	Manometer 40 mm 1/8" Bar/Psi	AC009.001	Rubber foot	AC021.003	Special connection 3/8" for pressure switch
AC005.002	Manometer 40 mm 1/4" Bar/Psi	AC010.001	Clip for tube 8,5 mm	AC023.001	Plastic Cover black for SILVERSTONE 2
AC006.001	Universal Coupler 1/4" Male	AC010.002	Clip for tube 8,0 mm	AC030.002	Tank model SILVERSTONE 2 electrical
AC006.004	Pin cock (Bayonet) 1/4" Male	AC010.003	Connection 1/4" Male for Rilsan tube 6 mm inside		